

Signage Program Design Concepts for

Original Submittal 4/27/2016



Front of House : Basic Code Signage

“Maximum compliance and affordability with a high-end look”



Optima Demi: AaBbCcDdEeFfGgHhIiJjKkLlMmN
OoPpQqRrSsTtUuVvWwXxYyZz
0123456789

The front-of-house code sign cocept was inspired by the generous use of colored marble throughout the public areas of the venue.

To maximize contrast and with it maximize compliance and readability we chose a marble from the darker end of the spectrum, much like the marble used for the private suite signs currently in use.

All edges and corners would be generously rounded to achieve a soft, approachable look.

The font family used in this design is *Optima*. A classic look with lines that bridge the gap between the two fonts currently in use: the legal but often stiff looking *Helvetica* and the elegant but non-compliant *Times Roman*.

All these elements combine to achieve a very high-end look becoming of the marbled halls of the Honda Center but at a reasonable price due to the use of high resolution

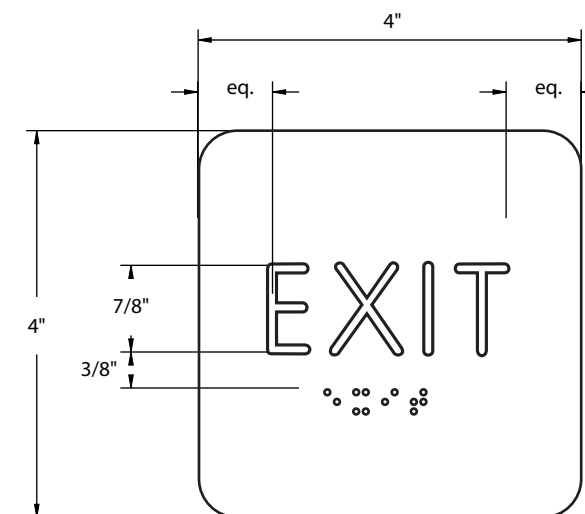
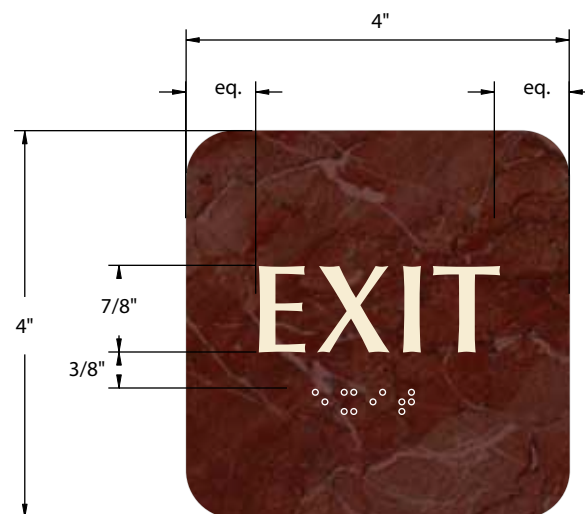

B Small Space Versions
Scale 1:2

C Invisible Version
Scale 1:2

The standard 8x4 sizes should be used in all instances except in situations where wall space is too limited.

Whenever needed the 4x4 small space versions may be used in instances of limited latch-side wall space.

The clear “invisible” version should only be used when visual (and/or illuminated) exit signs are present and clearly visible and where small visual exits signs would serve little purpose (e.g. at the main entrances with multiple doors)

A Standard Sizes
Scale 1:2

Project : [REDACTED]

Phase : ADA Signage

Owner :

Contractor :

Designer : Ullrich Hepperlin

Email : ullrich@tojico.com

Phone: (562) 212-9347

Original Submittal : 4/27/2016
Revision 01 Date :
Revision 02 Date :
Revision 03 Date :
Revision 04 Date :
Revision 05 Date :

Tactile Exit Signs

Sheet Size : 11"x17"

DRW-001

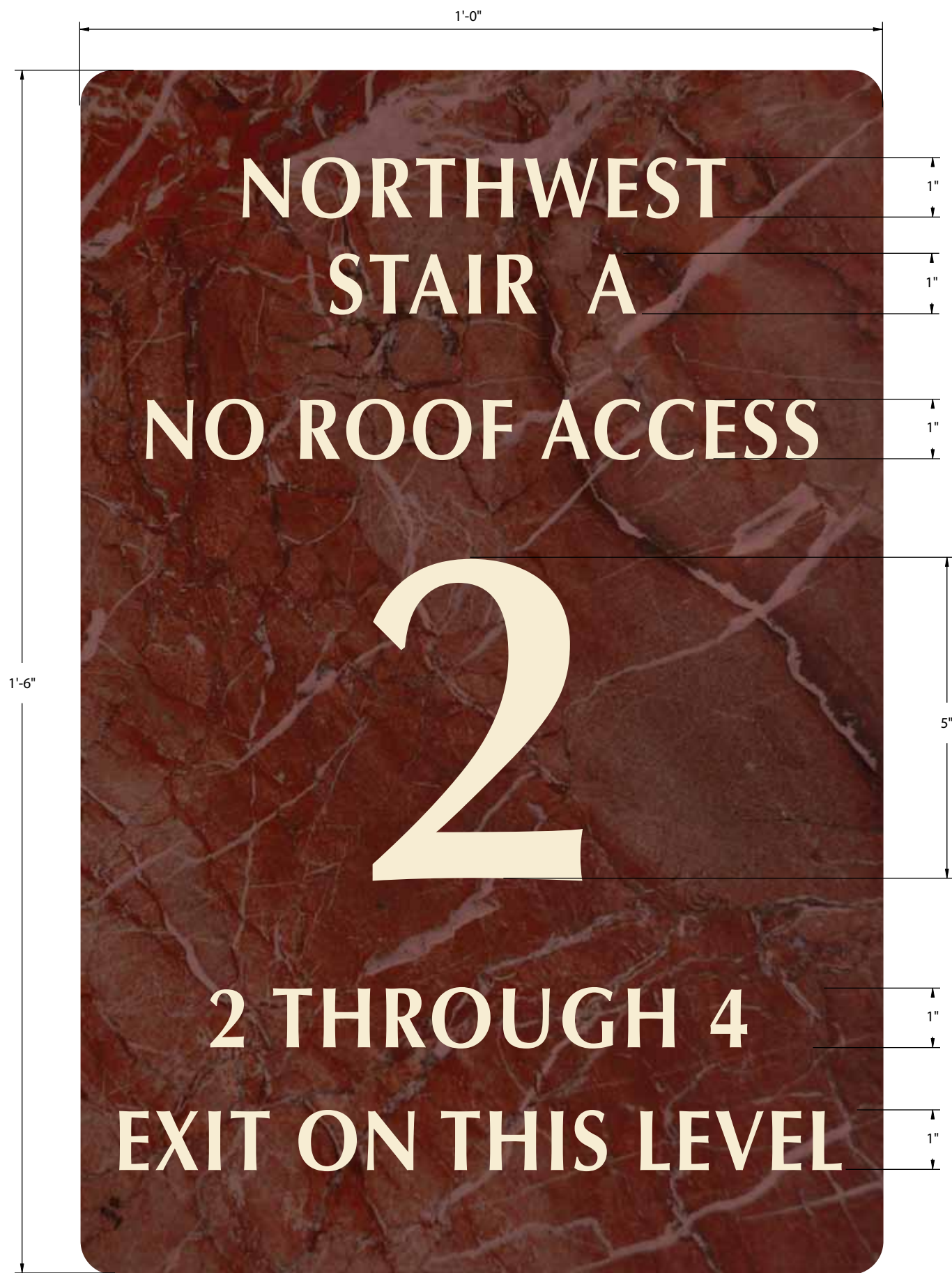

Stair Code ID
Scale 1:2

Both the large CA fire code sign as well as the much smaller braille/tactile floor ID are required inside most stairwells.

The stair code sign is exclusively visual and primarily contains vital information for fire department operations. The braille sign only identifies the floor a stairwell door leads to and whether it is an exit floor (identified by the star symbol).



Tactile Floor ID
Scale 1:2

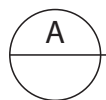

ADA Restroom Wall Sign (Unisex)

Scale 1:2

The ADA (and in turn the CBC) requires restroom facilities to be identified with a wall mounted sign including both braille & tactile description of the room’s function. The pictograms are not required but are considered best practices in a multi-language environment.



Access Communications

Signage Consultants
3700 Industry Ave #102
Lakewood, CA 90712
TEL (562) 423-6600
FAX (562) 981-8736

Project :



Phase : ADA Signage

Owner :

Contractor :

Designer : Ullrich Hepperlin

Email : ullrich@tojico.com

Phone: (562) 212-9347

Original Submittal : 4/27/2016

Revision 01 Date :

Revision 02 Date :

Revision 03 Date :

Revision 04 Date :

Revision 05 Date :

**ADA Unisex
Restroom
Wall Mounted
Signage**

Sheet Size : 11"x17"

DRW-003



For use on LIGHT colored doors

A

CBC Restroom Geometric Door Symbol (Unisex & Wheelchair Accessible)
Scale 1:2

The CBC requires these geometric door symbols to identify restrooms in addition to the ADA braille sign. The circle represents female facilities. The triangle represents male facilities. The triangle inside a circle represents a unisex restroom. These signs are required to contrast with the door they are mounted on, so this design includes versions for both light & dark colored doors.



For use on DARK colored doors

B

CBC Restroom Geometric Door Symbol (Unisex & Wheelchair Accessible)
Scale 1:2

The ISA (Wheelchair Symbol) or international symbol of accessibility is required to be posted at the entrance to accessible restroom facilities. In our design, the ISA is placed in the center of the geometric door sign, a space which would otherwise be left blank.

Project : [REDACTED]

Phase : ADA Signage
Owner :
Contractor :
Designer : Ullrich Hepperlin
Email : ullrich@tojico.com
Phone: (562) 212-9347

Original Submittal : 4/27/2016
Revision 01 Date :
Revision 02 Date :
Revision 03 Date :
Revision 04 Date :
Revision 05 Date :

CBC Unisex Restroom Door Mounted Signage

Sheet Size : 11"x17"

DRW-004

A

ADA Restroom Wall Sign (Women)
Scale 1:2

The ADA (and in turn the CBC) requires restroom facilities to be identified with a wall mounted sign including both braille & tactile description of the room’s function. The pictogram is not required but are considered best practices in a multi-language environment.



Access[™]

Communications

Access Communications

Signage Consultants
3700 Industry Ave #102
Lakewood, CA 90712
TEL (562) 423-6600
FAX (562) 981-8736

Project :

Phase : ADA Signage

Owner :

Contractor :

Designer : Ullrich Hepperlin

Email : ullrich@tojico.com

Phone: (562) 212-9347

Original Submittal : 4/27/2016

Revision 01 Date :

Revision 02 Date :

Revision 03 Date :

Revision 04 Date :

Revision 05 Date :

ADA Women’s Restroom Wall Mounted Signage

Sheet Size : 11”x17”

DRW-005

©2016 H. Toji & Compan y. All Rights Reserved.
All Drawings subject to US copyright law



For use on LIGHT colored doors



For use on DARK colored doors

A

CBC Restroom Geometric Door Symbol (Female & Wheelchair Accessible)
Scale 1:2

The CBC requires these geometric door symbols to identify restrooms in addition to the ADA braille sign. The circle represents female facilities. These signs are required to contrast with the door they are mounted on, so this design includes versions for both light & dark colored doors.

B

CBC Restroom Geometric Door Symbol (Female & Wheelchair Accessible)
Scale 1:2

The ISA (Wheelchair Symbol) or international symbol of accessibility is required to be posted at the entrance to accessible restroom facilities. In our design, the ISA is placed in the center of the geometric door sign, a space which would otherwise be left blank.

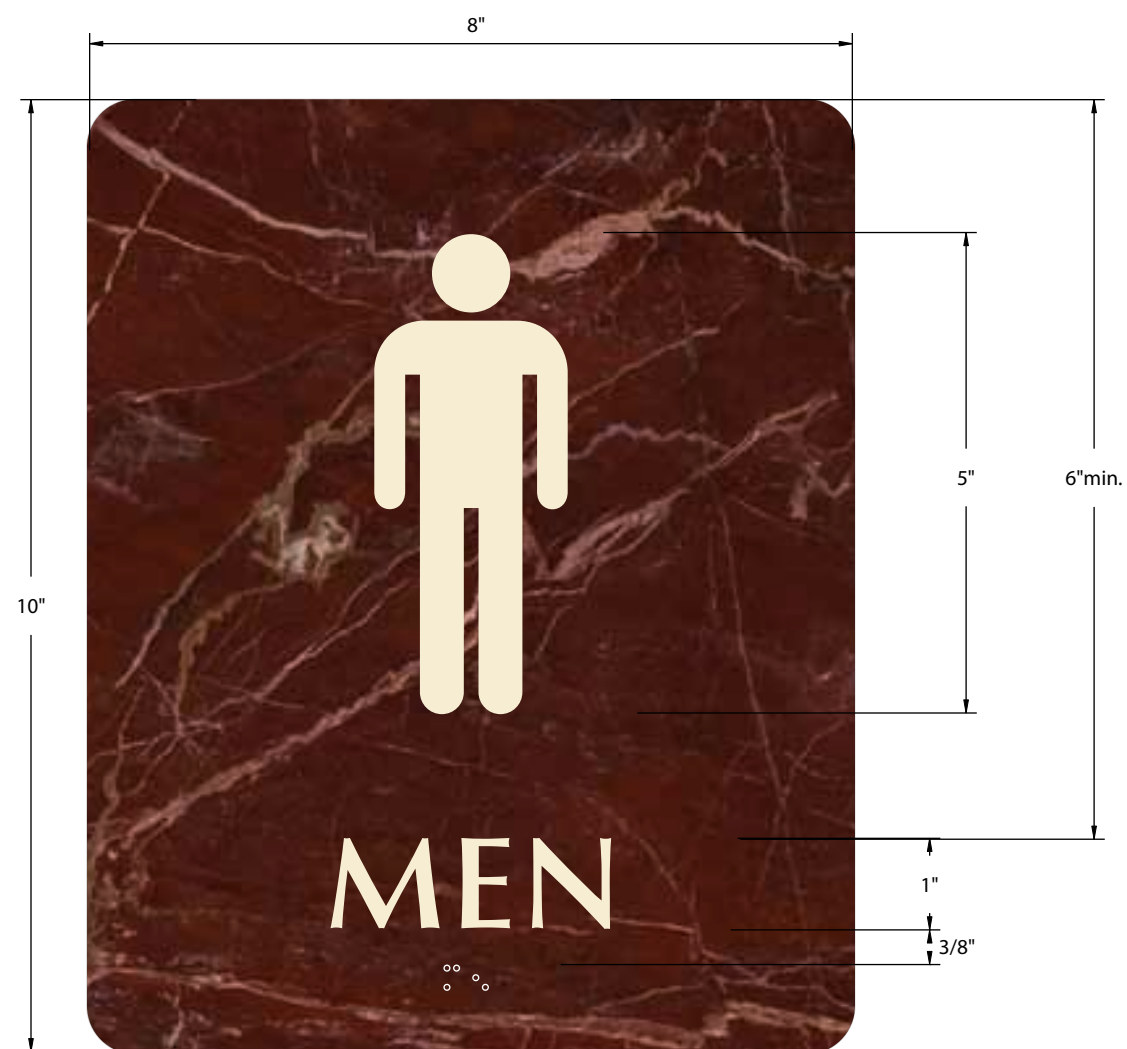

A

ADA Restroom Wall Sign (Men)

Scale 1:2

The ADA (and in turn the CBC) requires restroom facilities to be identified with a wall mounted sign including both braille & tactile description of the room's function. The pictogram is not required but are considered best practices in a multi-language environment.

Access Communications

Signage Consultants
3700 Industry Ave #102
Lakewood, CA 90712
TEL (562) 423-6600
FAX (562) 981-8736

Project :

Phase : ADA Signage

Owner :

Contractor:

Designer : Ullrich Hepperlin

Email : ullrich@tojico.com

Phone: (562) 212-9347

Original Submittal :4/27/2016

Revision 01 Date :

Revision 02 Date :

Revision 03 Date :

Revision 04 Date :

Revision 05 Date :

ADA Men's Restroom Wall Mounted Signage

Sheet Size : 11"x17"

DRW-007



For use on LIGHT colored doors

A CBC Restroom Geometric Door Symbol (Male & Wheelchair Accessible)
Scale 1:2

The CBC requires these geometric door symbols to identify restrooms in addition to the ADA braille sign. The triangle represents male facilities. These signs are required to contrast with the door they are mounted on, so this design includes versions for both light & dark colored doors.



For use on DARK colored doors

B CBC Restroom Geometric Door Symbol (Male & Wheelchair Accessible)
Scale 1:2

The ISA (Wheelchair Symbol) or international symbol of accessibility is required to be posted at the entrance to accessible restroom facilities. In our design, the ISA is placed in the center of the geometric door sign, a space which would otherwise be left blank.



For use on LIGHT colored walls

A ADA/CBC Restroom Combo Sign (Female & Wheelchair Accessible)
Scale 1:2

Where geometric door symbols are required, but no doors are present as is many stadium facilities, the ADA braille/tactile sign and CBC geometric door symbol may be combined into this "combo" sign.



For use on DARK colored walls

B ADA/CBC Restroom Combo Sign (Female & Wheelchair Accessible)
Scale 1:2



For use on LIGHT colored walls

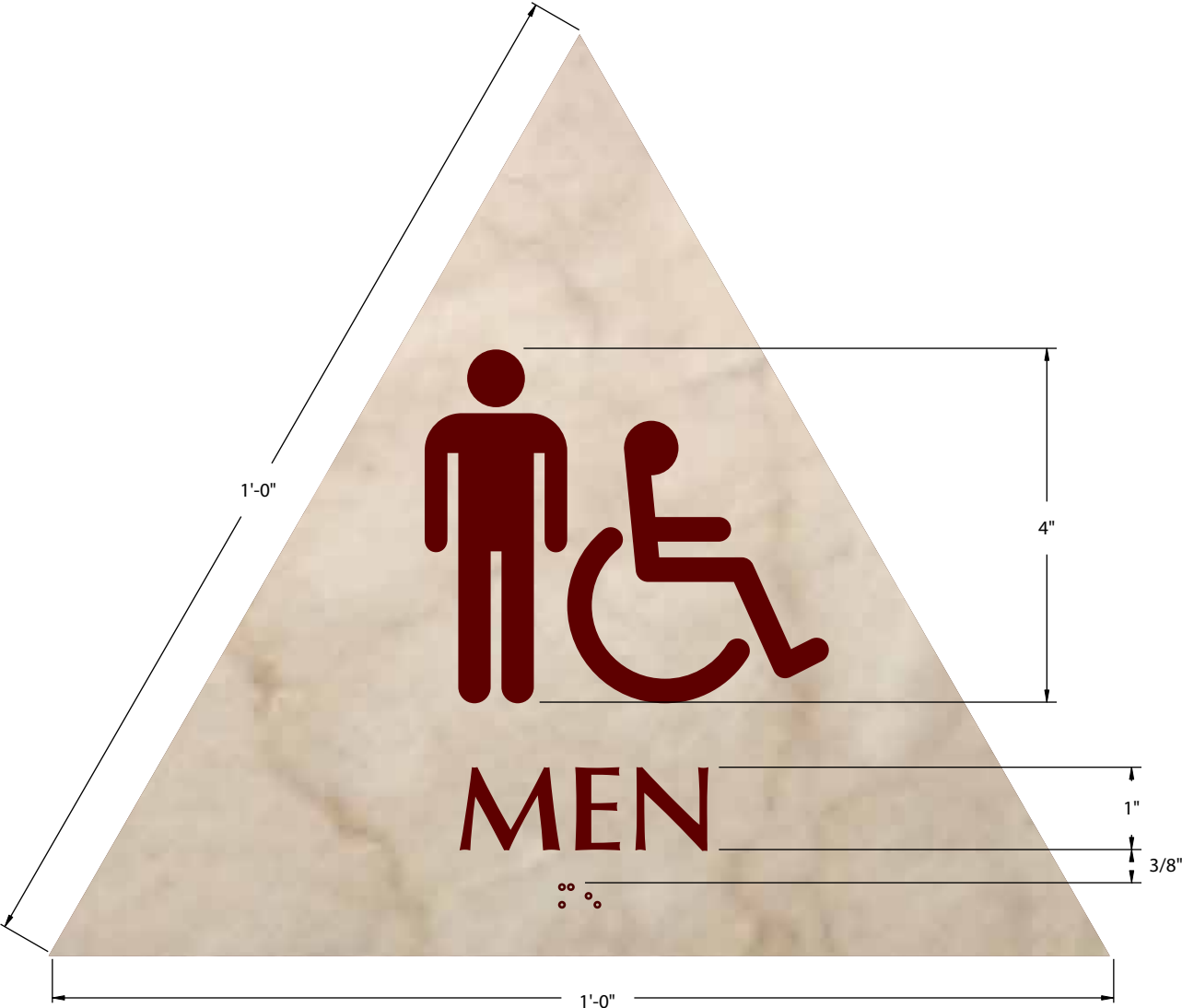

For use on DARK colored walls

A ADA/CBC Restroom Combo Sign (Male & Wheelchair Accessible)
Scale 1:2

Where geometric door symbols are required, but no doors are present as is many stadium facilities, the ADA braille/tactile sign and CBC geometric door symbol may be combined into this “combo” sign.

B ADA/CBC Restroom Combo Sign (Male & Wheelchair Accessible)
Scale 1:2

Access Communications
Signage Consultants
3700 Industry Ave #102
Lakewood, CA 90712
TEL (562) 423-6600
FAX (562) 981-8736

Project : [REDACTED]

Phase : ADA Signage

Owner :

Contractor :

Designer : Ullrich Hepperlin

Email : ullrich@tojico.com

Phone: (562) 212-9347

Original Submittal : 4/27/2016
Revision 01 Date :
Revision 02 Date :
Revision 03 Date :
Revision 04 Date :
Revision 05 Date :

**Room
Identification:
Suite Sign
Retrofit**

Sheet Size : 11"x17"

DRW-011

©2016 H. Toji & Company, All Rights Reserved.
All Drawings subject to US copyright law

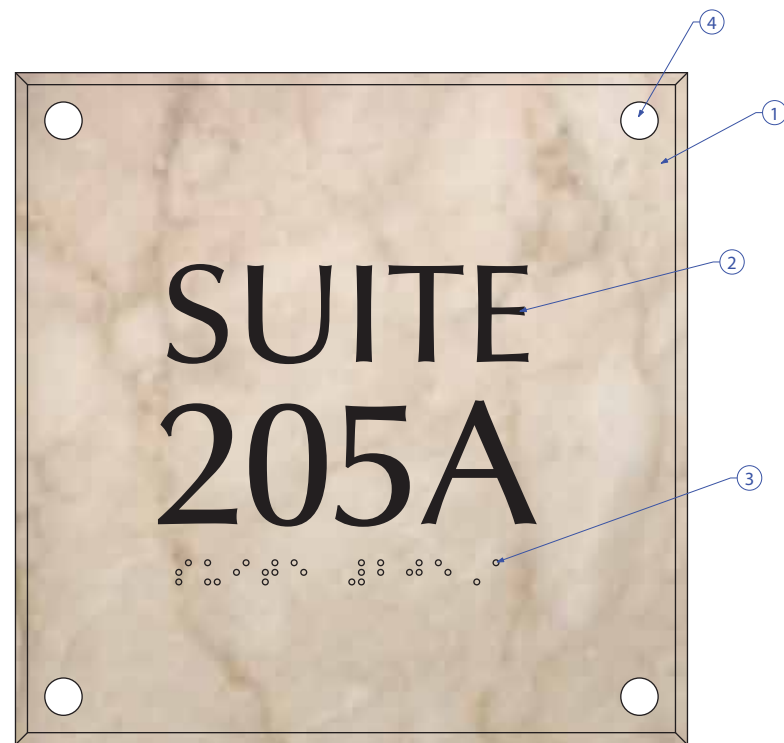

ADA Retrofit Plaque

- 1 - 1/8" thick clear cast acrylic non-glare finish - digital print graphic on 2nd surface (to match white marble) w/ beveled edges
- 2 - 1/32" thick engraving stock w/ beveled edges laminated to sign face (black)
- 3 - CA compliant clear acrylic raster braille w/ grade-2 translation
- 4 - 3/8" dia. holes cut to accomodate existing brass caps
- 5 - Existing brown marble plaque
- 6 - Existing polished brass stand-off cap
- 7 - Existing engraved graphics

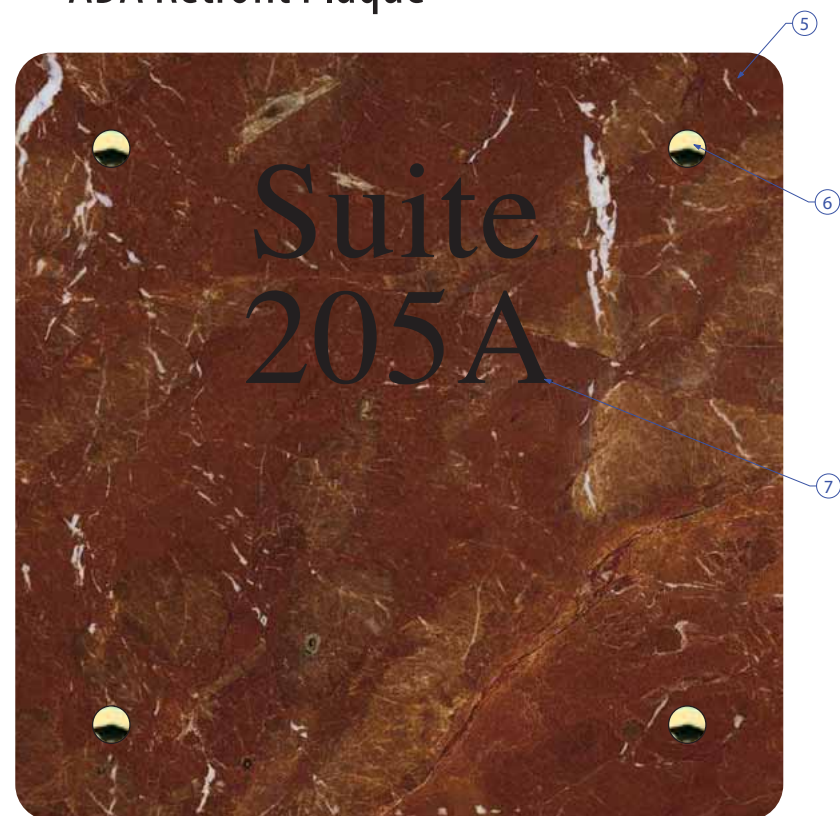

Existing Signage



Sign After Retrofit

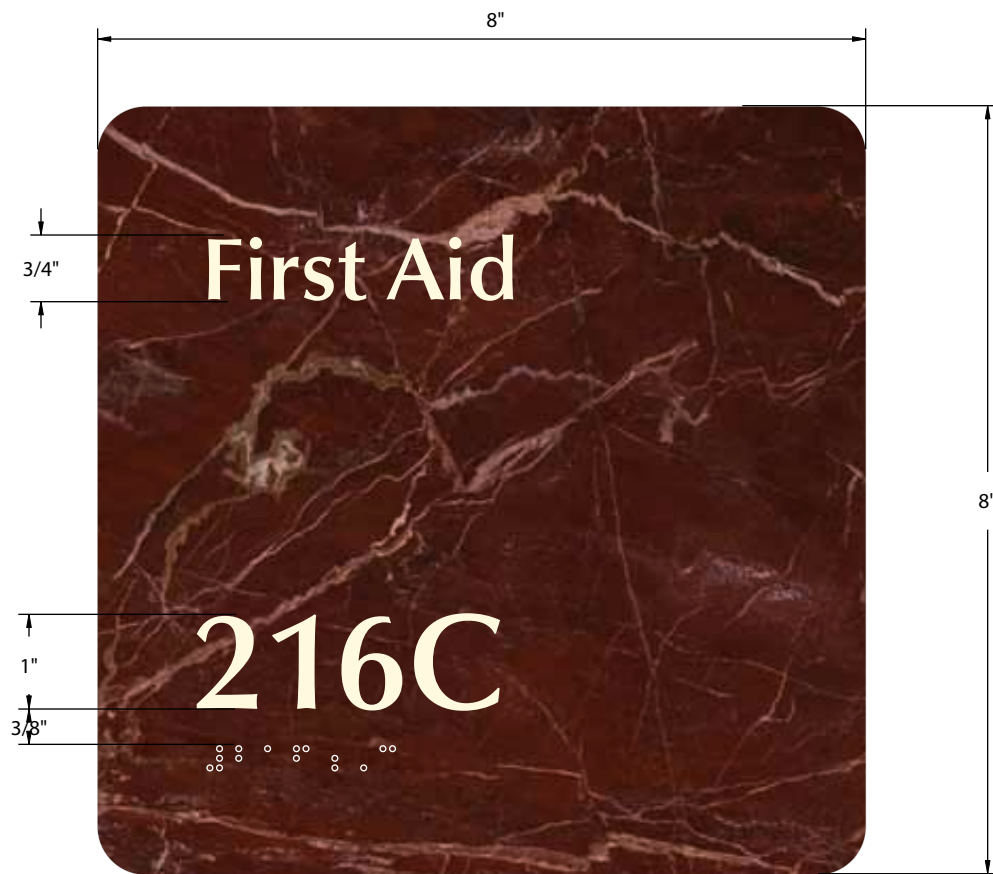

A Room IDs for Main Concourse (Level 2)
Scale 1:2

Many room entrances off the main concourse are probably utility or staff-only rooms and should not be identified at all.



B Room IDs for Offices (Mezzanine Level)
Scale 1:2



C Room IDs for Main Concourse (Level 3)
Scale 1:2

Project : 

Phase : ADA Signage

Owner :

Contractor :

Designer : Ullrich Hepperlin

Email : ullrich@tojico.com

Phone: (562) 212-9347

Original Submittal : 4/27/2016
Revision 01 Date :
Revision 02 Date :
Revision 03 Date :
Revision 04 Date :
Revision 05 Date :

**Room
Identification:
Front-of-House
& Offices**

Sheet Size : 11"x17"

DRW-012

©2016 H. Toji & Company. All Rights Reserved.
All Drawings subject to US copyright law



Room ID retrofit for Press Level

Scale 1:2

The existing signs are more or less legal as visual signs, so an “invisible” tactile/braille bar can be added to the bottom of each sign to make it ADA/CBC compliant.

Access Communications

Signage Consultants
3700 Industry Ave #102
Lakewood, CA 90712
TEL (562) 423-6600
FAX (562) 981-8736

Project :



Phase : ADA Signage

Owner :

Contractor :

Designer : Ullrich Hepperlin

Email : ullrich@tojico.com

Phone: (562) 212-9347

Original Submittal : 4/27/2016

Revision 01 Date :

Revision 02 Date :

Revision 03 Date :

Revision 04 Date :

Revision 05 Date :

**Room
Identification:
Press Level
Retrofit**

Sheet Size : 11”x17”

DRW-013



A Room IDs for Basement Level (B.O.H.)
Scale 1:2

This design only differs from the front of house design in that it uses thinner, less expensive materials and a solid color instead of a digital marble print.

Access Communications
Signage Consultants
3700 Industry Ave #102
Lakewood, CA 90712
TEL (562) 423-6600
FAX (562) 981-8736

Project : [REDACTED]

Phase : ADA Signage

Owner :

Contractor :

Designer : Ullrich Hepperlin

Email : ullrich@tojico.com

Phone: (562) 212-9347

Original Submittal : 4/27/2016
Revision 01 Date :
Revision 02 Date :
Revision 03 Date :
Revision 04 Date :
Revision 05 Date :

**Room
Identification:
Back-of-House**

Sheet Size : 11"x17"

DRW-014



min. 3" tall lettering



min. 3" tall lettering

A Overhead Wayfinding Signs on Concourse
 Scale NTS



min. 2 1/2" tall lettering



B Overhead Wayfinding Signs above Doors
 Scale NTS

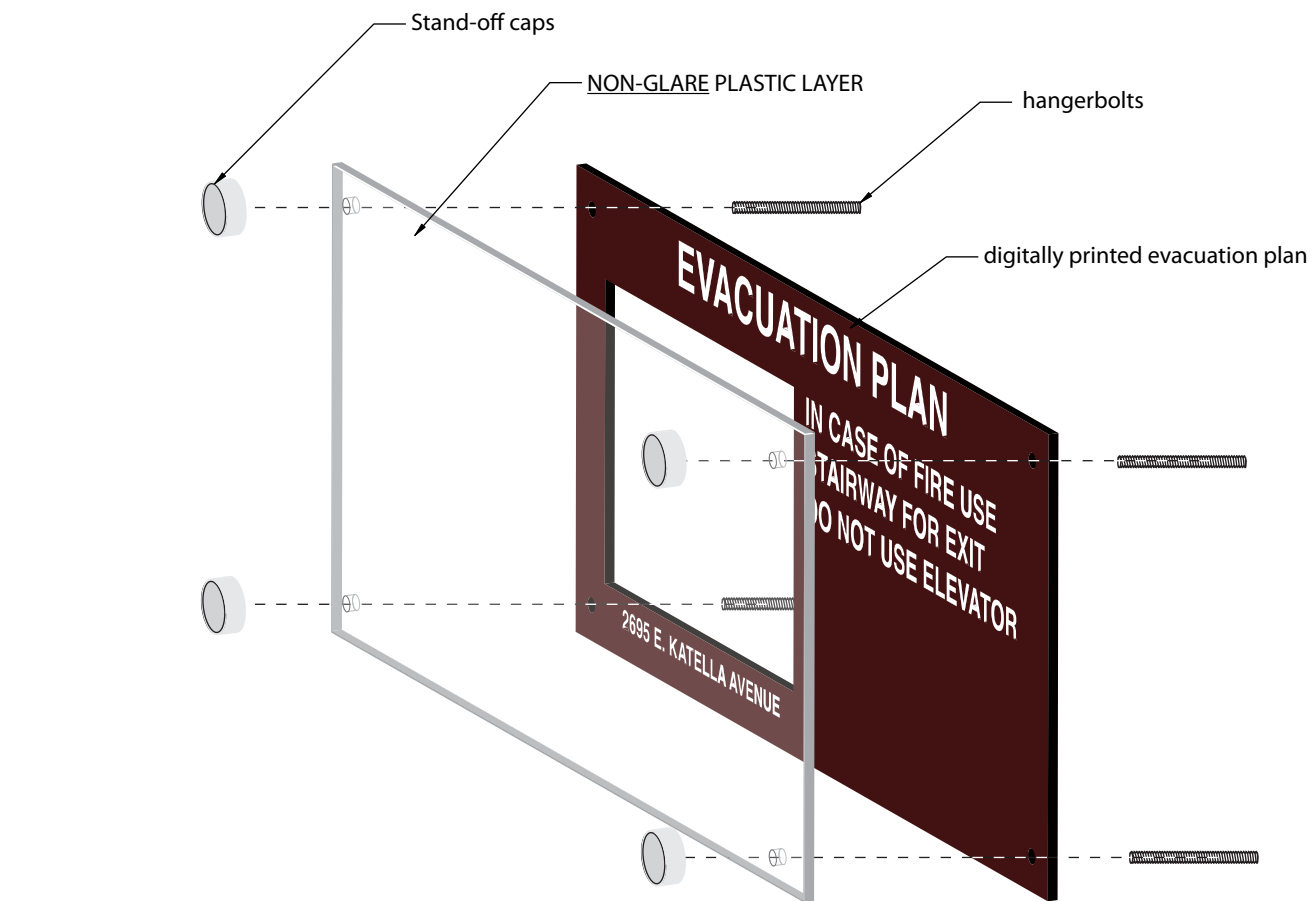

A Retrofit of Existing Evacuation Plans
Scale NTS

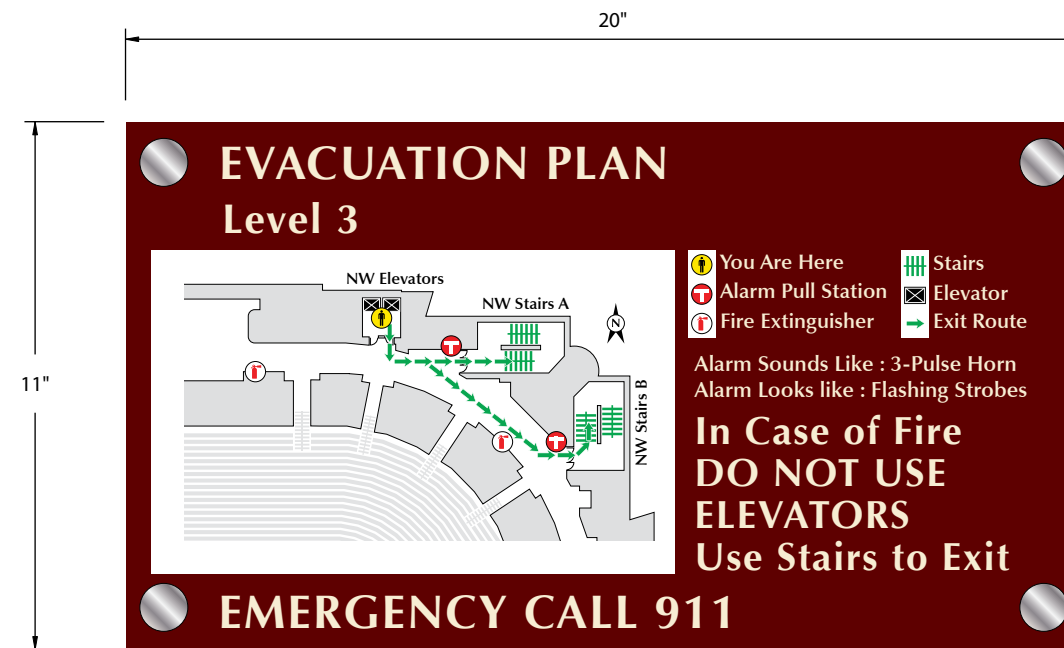

B Typical Evacuation Plan
Scale 1:4

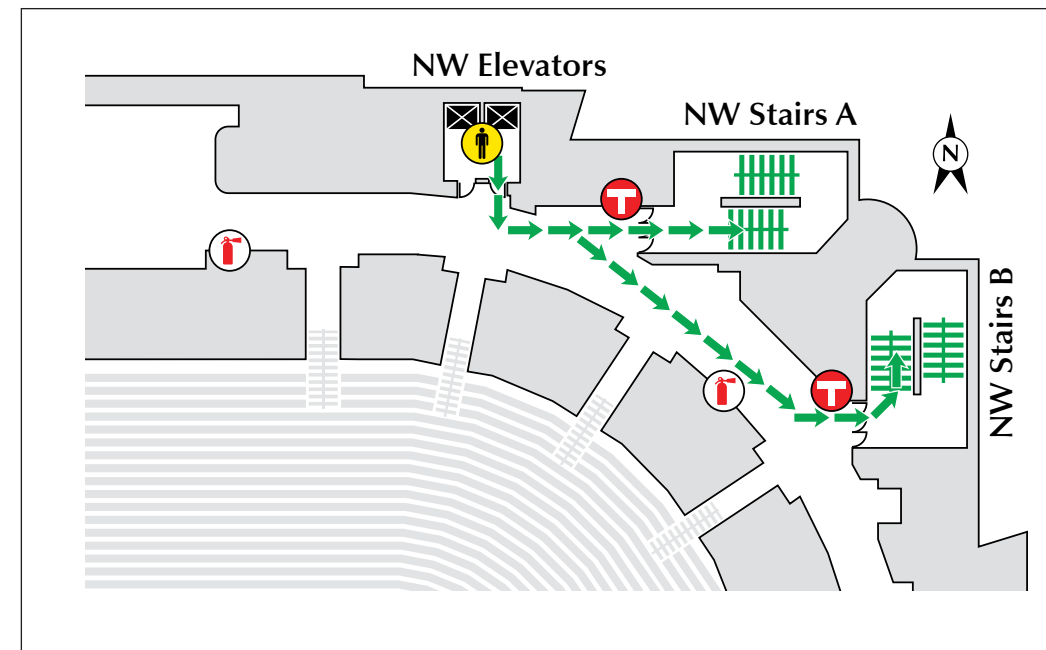

C Enlarged Map Detail
Scale 1:2



A Informational Signs Regarding Accessible Facilities (e.g. at ticket windows)
Scale 1:4

ATTENTION



Elevator Access
Limited to:
Club Seat or
Suite-holders and
Guests Requiring
Assistance.
Thank You.

ATTENTION



Clean Up After Yourself!
Put Your Tools Away!
No Tools Left Out!
Thank You.

ATTENTION



EXIT ONLY
All guests must show
ticket and hand stamp
for re-entry. Please go
to South, North or East
entrance to receive a
hand stamp.
Thank You.



WARNING

This area contains chemicals
known to the State of California
to cause cancer, birth defects and
other reproductive harm.

Use appropriate protective gear.



The existing brass lettering is mirror-polished and too reflective to be ADA compliant. Some of the lettering is also too closely spaced to be compliant.

Furthermore, during our site walk, we discovered that many of these very heavy metal objects are loose and in danger of falling, potentially insuring someone.

A Existing Overhead Section Numbers
Scale NTS

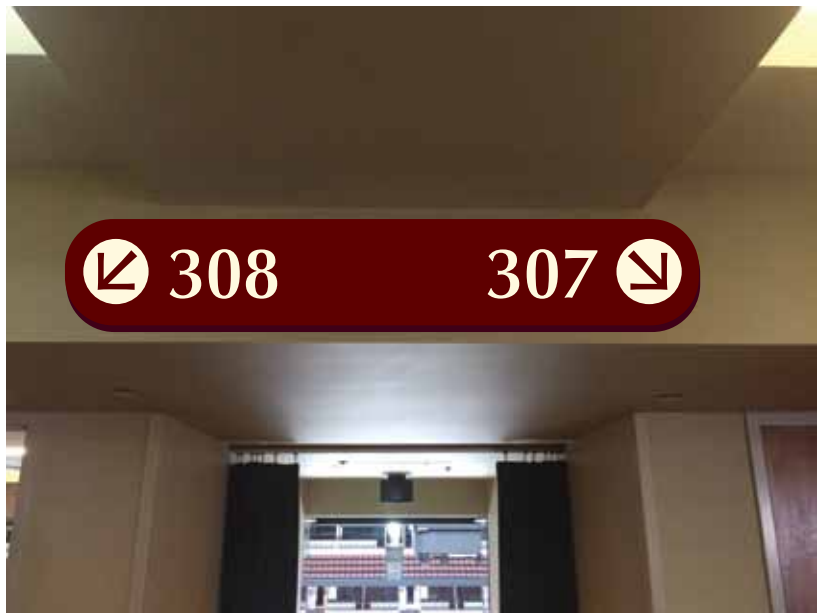

The proposed replacement panels would cover the old lettering, or any holes left visible in the walls after removal.

These panels can be made as continuous sign pans with flush or dimensional graphics for a more high-end look.

B Proposed Overhead Section Numbers Retrofit
Scale NTS

AccessTM
Communications

Access Communications

Signage Consultants
3700 Industry Ave #102
Lakewood, CA 90712
TEL (562) 423-6600
FAX (562) 981-8736

Project :
2
7

Phase : ADA Signage

Owner :

Contractor :

Designer : Ullrich Hepperlin

Email : ullrich@tojico.com

Phone: (562) 212-9347

Original Submittal : 4/27/2016
Revision 01 Date :
Revision 02 Date :
Revision 03 Date :
Revision 04 Date :
Revision 05 Date :

Overhead
Section
Numbers

Sheet Size : 11"x17"

DRW-019

©2016 H. Toji & Compan y. All Rights Reserved.
All Drawings subject to US copyright law